

Rt. Gilmore

No 3342

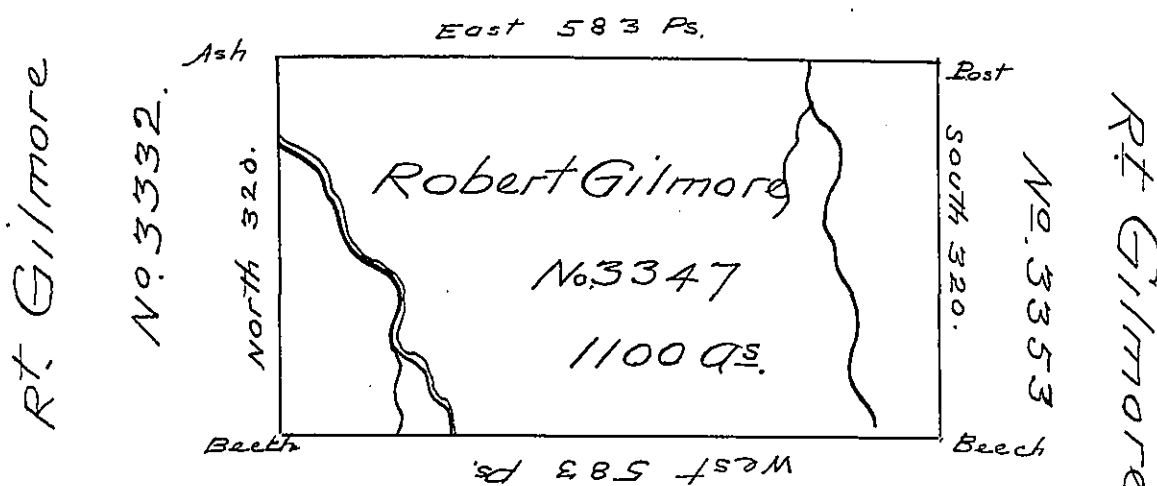

No 2191

Rt. Gilmore

Situate on the East Branch of Ischu-
nuangwant Creek Six miles South of the
State Line District No. 4 in the last Purchase
Surveyed June the Twenty ninth 1793 in
pursuance of a Warrant to Robert Gilmore
No 3347 Dated the fourteenth day of De-
cember 1792 for 1000 acres

Containing Eleven hundred acres and the
usual allowance of Six Per Ct. for Roads.

Pr. James Hunter D.S.

To Daniel Brodhead Esq. S. G.

June 29th

IN TESTIMONY that the above is a copy of the original remaining on file in
the Department of Internal Affairs of Pennsylvania, made
conformably to an Act of Assembly approved the 16th day of
February, 1833, I have hereunto set my Hand and caused
the Seal of said Department to be affixed at Harrisburg,
this Twenty sixth day of October 1904.

James P. Brown
Secretary of Internal Affairs.